



Department of Public Works
Engineering Division
Robert F. Phillips, P.E., City Engineer
City-County Building, Room 115
210 Martin Luther King, Jr. Boulevard
Madison, Wisconsin 53703
Phone: (608) 266-4751
Fax: (608) 264-9275
engineering@cityofmadison.com
www.cityofmadison.com/engineering

Deputy City Engineer
Gregory T. Fries, P.E.
Deputy Division Manager
Kathleen M. Cryan
Principal Engineer 2
Christopher J. Petykowski, P.E.
John S. Fahrney, P.E.
Principal Engineer 1
Christina M. Bachmann, P.E.
Mark D. Moder, P.E.
Janet Schmidt, P.E.
James M. Wolfe, P.E.
Facilities & Sustainability
Bryan Cooper, Principal Architect
Mapping Section Manager
Eric T. Pederson, P.S.
Financial Manager
Steven B. Danner-Rivers

August 29, 2019

**NOTICE OF ADDENDUM
ADDENDUM NO. 1**

**CONTRACT NO. 8459, PROJECT NO. 10955
MPD-Central District Paint & Flooring Replacement**

This addendum is issued to modify, explain or correct the original Drawings, Specifications, or Contract Documents marked as ***MPD-Central District Paint & Flooring Replacement, City of Madison, Contract #8459, as issued on August 08, 2019*** and is hereby made a part of the contract documents.

This addendum consists of the following documents:

- **Drawings A1; A2; A3; A4;**
- **Specification Pages (09 68 13-1) thru (09 91 23-3)**
- **Pre-Bid Walkthrough (08-15-2019) and (08-20-2019) Sign-in Sheets**
- **Exhibit C: 8459 Test Report CCB Police Remodel Abatement**

Please attach these Addendum documents to the Drawings and Project manual in your possession.

GENERAL CONTRACT CONDITIONS:

This section is not used.

GENERAL QUESTIONS AND ANSWERS:

- A. Q: Borrowed lights and frames not indicated on plans.
A: Please see revised sheet A1 for clearstory windows at the northwest corner of the project.
- B. Q: Removal of the Vinyl Base - where should it go as it is removed?
A: An area will be designated as each area is phased. Vinyl base should be removed from the site and recycled by the Flooring contractor.
- C. Q: Should the vinyl base be removed and replaced in the rooms that are being painted, but not having carpet installed?
A: Yes.
- D. Q: Should cable trays and electrical conduit be painted to match the wall color?
A: Cable trays and conduit that are currently painted to match existing walls shall be repainted.

- E. Q: Are there any areas that require epoxy type paint?
A: No epoxy paint is required on this project.
- F. Q: Corridor Ceiling height vs Office/Work area ceiling height
A: See Sheet A1 and A2 for clarifications.
- G. Q: Is there an area we can stage needed equipment?
A: Staging will be allowed in the old lineup and fingerprint rooms #1104 & 1105
- H. Q: Wall corners have a lot of damage. Is there an allowance for patching?
A: Patching at wall corners to approximately 52" above finished floor will not be required. This is a lump sum total bid project with no allowances. Forty-Seven (47) "BluNose High Impact Corner Guards" x 48"lg. (color to be verified) to be furnished and installed by the general contractor after painting is completed. See Sheet A1 & A2 for locations.
- I. Q: Should we float the floor to transition between the walk-off tile that is placed over the existing terrazzo floor and the new carpet?
A: Yes, please float the floor so that a transition strip is not required between the carpet tile and the walk-off tile.
- J. Q: What type of base is required at the carpet and rubber floors?
A: Please provide straight base at carpet and coved base at the hard surface floors.
- K. Q: At locations where carpet is to be placed over rubber flooring, what installation method do you prefer?
A: Please use the Mohawk tab system to preserve the integrity of the rubber floor for future.
- L. Q: There appear to be 9x9 tiles under the existing carpet? Are there asbestos concerns?
A: Please see the attached Exhibit C "8459 Test Report CCB Police Remodel Abatement" that indicates 9"x9" Gray tiles tested negative in the 2008 remodeling project.
- M. Q: Are the pipes and HVAC in the training room painted?
A: Only the wall surfaces shall be painted.

ACCEPTABLE EQUIVALENTS

This section is not used.

SPECIFICATIONS

- A. **Updates** to Specification 09 68 13 Carpet Tile: Section 2.1A Carpet Tiles
- B. **Updates** to Specification 09 91 23 Interior Painting Section 2.3 Colors

DRAWINGS

- A. Drawing A1 (remove and replace). Drawing revised to indicate clearstory windows, corner guard locations, add one accent wall and clarify ceiling heights.
- B. Drawing A2 (remove and replace). Drawing revised to add corner guard locations and clarify ceiling heights.
- C. Drawing A3 (remove and replace). Drawing revised to show location of existing terrazzo floor to receive walk-off tile. And existing room with rubber flooring to receive carpet tiles.
- D. Drawing A4 (remove and replace). Drawing revised to show room with existing rubber flooring to receive carpet tiles.

PROPOSAL

No Change

Please acknowledge this addendum on page E1 of the contract documents and/or in Section E: Bidder's Acknowledgement on Bid Express.

Electronic version of these documents can be found on the Bid Express web site at:

<http://www.bidexpress.com>

If you are unable to download plan revisions associated with the addendum, please contact the Engineering office at 608-266-4751 receive the material by another route.

Sincerely,



Robert F. Phillips, P.E., City Engineer



Cc: Greg Fries, Kathy Cryan

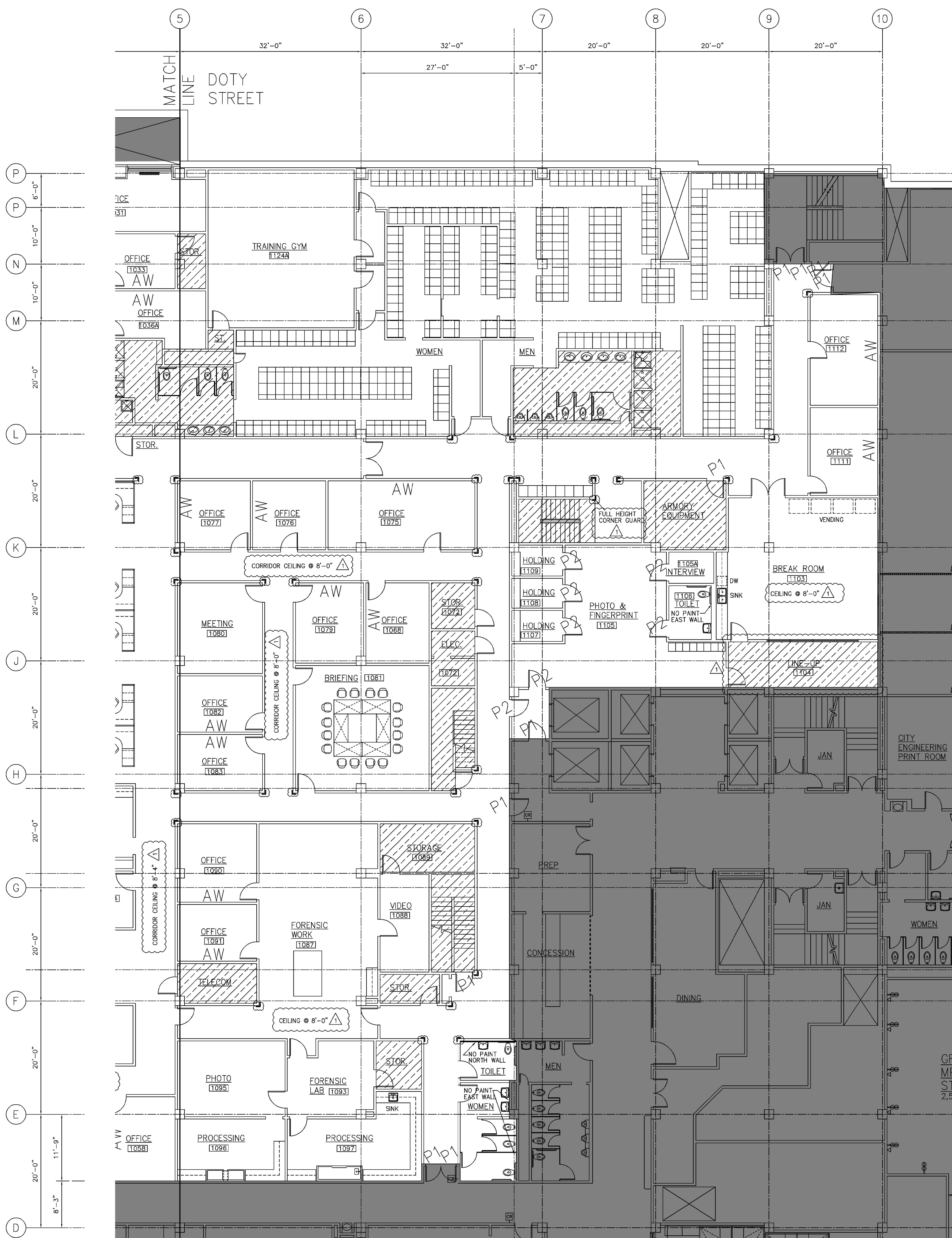

GENERAL NOTES

- 1. CEILING HEIGHT IN ROOMS 9'-4" U.N.O.
CEILING HEIGHT IN CORRIDORS 7'-4" U.N.O.
- 2. CEILINGS ARE NOT PAINTED
- 3. SEE SPEC 099123-INTERIOR PAINT FOR PAINT COLORS AND TYPES.
- 4. WOOD DOORS ARE NOT PAINTED - SEE P1 AND P2 FOR METAL DOORS TO BE PAINTED

PLAN NORTH

PAINTING FLOOR PLAN - EAST
SCALE: 1/8" = 1'-0"

■ DENOTES: AREA NOT IN CONTRACT

▨ DENOTES: PAINTING NOT REQ'D UNLESS NOTED

AW: ACCENT WALL COLOR VERIFY WALL W/OWNER

P1: METAL DOOR - PAINT ONE SIDE (PROJECT SIDE)

P2: METAL DOOR - PAINT BOTH SIDES

1 DENOTES: CLEARSTORY WINDOWS @ 6'-8" A.F.F. (INCLUDES TRANSOM WINDOW ABOVE DOOR)

1 DENOTES: BLUNOSE HIGH IMPACT CORNER GUARDS X 48" LG U.N.O.; COLOR: TBD



CITY OF MADISON
DEPT. OF PUBLIC WORKS
ENGINEERING DIVISION
CITY COUNTY BLDG. RM. 115
210 MARTIN LUTHER KING JR. BLVD
MADISON, WI 53703
PHONE: 608-265-1751

MPD CENTRAL DISTRICT PAINT & FLOORING REPLACEMENT
211 SOUTH CARROLL STREET
MADISON, WI

CONTRACT #8459
MUNIS #10955
DRWN BY: LKA
DATE 08/08/19
REV: 08/28/19

SHT A2



CITY OF MADISON
 DEPT. OF PUBLIC WORKS
 ENGINEERING DIVISION
 CITY COUNTY BLDG. RM. 115
 210 MARTIN LUTHER KING, JR. BLVD.
 MADISON, WI 53703
 PHONE: 608-266-1751

MPD CENTRAL DISTRICT PAINT & FLOORING REPLACEMENT
 211 SOUTH CARROLL STREET
 MADISON, WI

CONTRACT #8459
 MUNIS #10955
 DRWN BY: LKA
 DATE: 08/08/19
 REV: 08/28/19

SHT A4

GENERAL NOTES

- SEE SPEC 096813-CARPET TILE FOR CARPET AND WALK-OFF TILE TYPE AND COLOR
- VINYL COVE BASE TO BE JOHNSONITE, TRADITIONAL; 6" HIGH X 1/8" THICK; COLOR: Black (40)

1 STRAIGHT BASE @ CARPET AND WALK-OFF TILES
 COVED BASE @ HARD SURFACE FLOORS

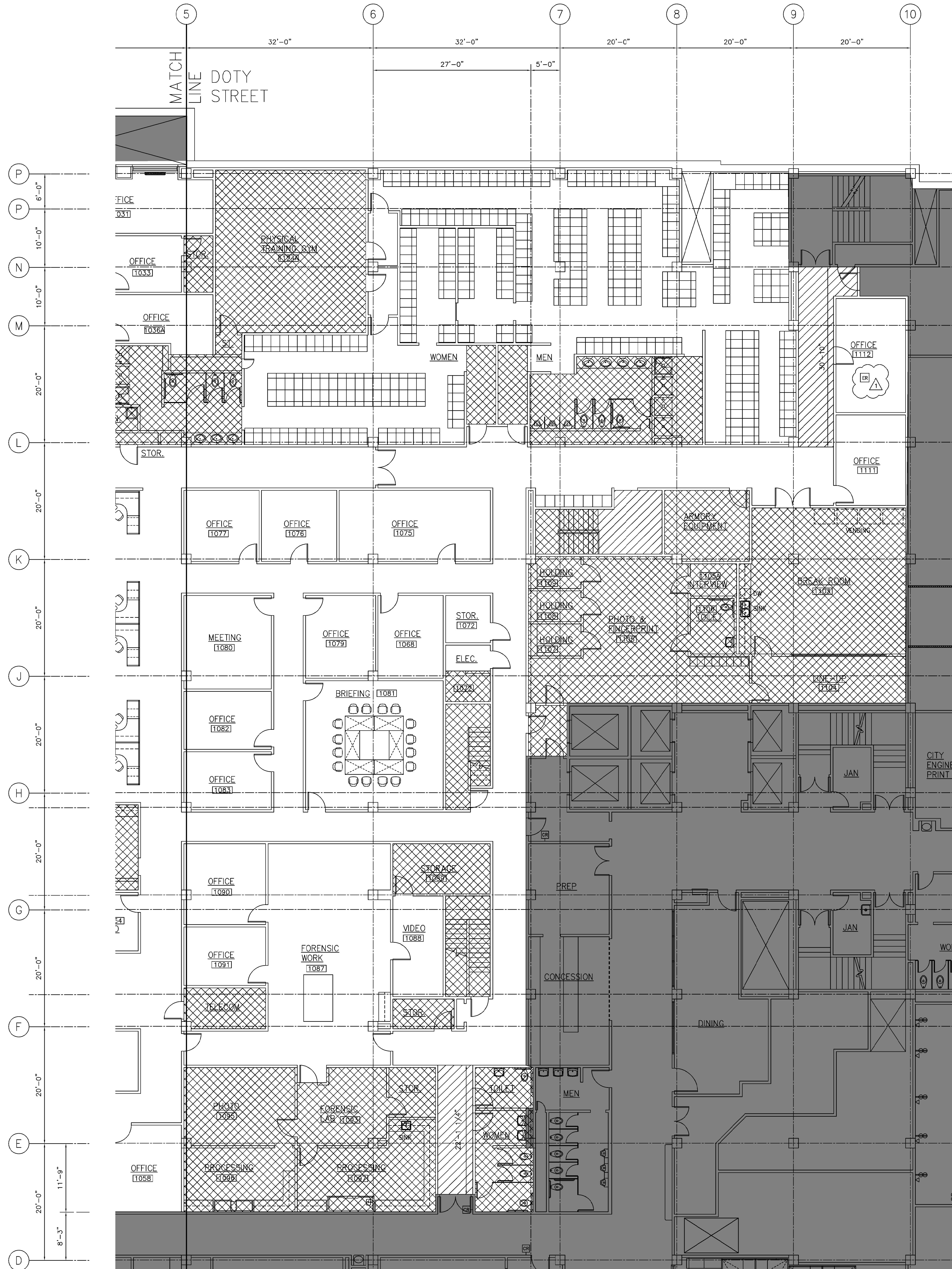

- PLAN NORTH
- FLOORING REPLACEMENT - EAST
SCALE: 1/8" = 1'-0"
 - DENOTES: AREA NOT IN CONTRACT
 - ▨ DENOTES: WALK-OFF TILE
 - ▩ DENOTES: EXISTING TILE/RUBBER FLOORING TO REMAIN

ER EXISTING RUBBER FLOORING TO REMAIN UNDER NEW CARPET TILE. INSTALL USING TAB SYSTEM TO RETAIN RUBBER FLOOR INTEGRITY FOR FUTURE USE

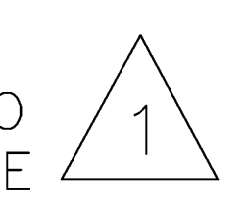

**SECTION 09 68 13
CARPET TILE**

1
2
3
4 PART 1 – GENERAL 1
5 1.1. SUMMARY 1
6 1.2. RELATED SPECIFICATIONS 1
7 1.3. REFERENCE STANDARDS 1
8 1.4. SUBMITTALS 1
9 1.5. PRE-INSTALLATION MEETINGS 1
10 1.6. QUALITY ASSURANCE 2
11 1.7. WARRANTY 2
12 PART 2 – PRODUCTS 2
13 2.1. MATERIALS 2
14 2.2. INSTALLATION ACCESSORIES 2
15 PART 3 - EXECUTION 2
16 3.1. EXAMINATION 2
17 3.2. PREPARATION 2
18 3.3. INSTALLATION 3
19 3.4. CLEANING AND PROTECTION 3
20

PART 1 – GENERAL

1.1. SUMMARY

- A. Carpet tile
- B. Adhesives and accessories
- C. Floor Preparation
- D. Removal of existing carpet tile.

1.2. RELATED SPECIFICATIONS

- A. SECTION 01 74 19 Construction Waste Management and Disposal

1.3. REFERENCE STANDARDS

- A. CRI 104 – Standard for Installation of Commercial Carpet; Carpet and Rug Institute; 2015

1.4. SUBMITTALS

- A. Product Data: Submit manufacturer’s product data for each type of carpet tile material and installation accessories required. Submit manufacturer’s printed data on physical characteristics, durability, fade resistance, and fire-tested response characteristics. Submit methods of installation for each type of substrate.
- B. Samples: Submit two full size samples of each type of carpet tile specified for verification purposes, showing full range of color, texture, and pattern variations expected. Prepare samples from same material to be used for the project. Label each sample with manufacturer’s name, material description, color, pattern, and designation indicated on drawings and/or room finish schedule.
- C. Manufacturer’s Installation Instructions: Indicate special procedures.
- D. Maintenance Data: Submit maintenance data for each type of carpet tile to include in operation and maintenance manual. Include recommended maintenance materials and suggested schedule for cleaning.
- E. Attic Stock: Furnish quantity equal to 3% for each type and color of carpet tile installed.
 - 1. Deliver extra carpet tile materials to Owner’s designated storage space, properly package with protective covering and identified with labels describing contents.

1.5. PRE-INSTALLATION MEETINGS

- A. Pre-installation Conference: Conduct conference at Project site.
 - 1. Review methods and procedures related to carpet tile installation including, but not limited to the following:
 - a. Review delivery, storage, and handling procedures.
 - b. Review ambient conditions and ventilation procedures.
 - c. Review subfloor preparation procedures
 - d. Review carpet installation layout

- 1 **1.6. QUALITY ASSURANCE**
2 A. Installer Qualifications: Engage an experienced Installer with a minimum of five (5) years of successful experience
3 in carpet tile installation of similar in size and type to the carpeting requirements of this project.
4
- 5 **1.7. WARRANTY**
6 A. Manufacturer's Warranty: Manufacturer agrees to repair or replace components of carpet tile installation that
7 fail in materials or workmanship within specified warranty period. Failures include, but not limited to more than
8 10 percent loss of face fiber, tile curling, snags, runs and delamination that are not due to usual traffic, failure of
9 substrate, vandalism or abuse.
10 B. Warranty Period: Ten (10) years from date of Substantial Completion.
11 C. Installer's Warranty: Submit a certificate guaranteeing the installation to be free of defects in workmanship for a
12 period of one year. Installer will correct and/or replace any improper work and material upon written notice
13 from the Owner or their representative.
14

15 **PART 2 – PRODUCTS**

- 16
17 **2.1. MATERIALS**
18 A. Carpet Tiles
19 1. Mohawk Art Style / Disruptive Path
20 a. Color: 955 Cosmic Sky
21 b. Size: 12"x36"
22 c. Installation: Half Lap
23 d. 80% coverage intermixed with "Shared Path"
24 B. Carpet Tiles
25 1. Mohawk Art Style / Shared Path
26 a. Color: 989 Charcoal
27 b. Size: 12"x36"
28 c. Installation: Half Lap
29 d. 20% coverage intermixed with "Disruptive Path"
30 C. Walk-off Tiles
31 1. Mohawk Tuff Stuff II Collection / Step Up II
32 a. Color: 955 Cobalt
33 b. Size: 24"x24"
34 b. Installation: Quarter Turn
35

- 36 **2.2. INSTALLATION ACCESSORIES**
37 A. Trowelable leveling and Patching Compounds: Latex modified, hydraulic cement based formulation provided or
38 recommended by carpet tile manufacturer for applications indicated.
39 B. Adhesive: Water-resistant, mildew resistant, non-staining, pressure-sensitive type to suit products and subfloor
40 conditions indicated, that complies with flammability requirement for installed carpet tile and is recommended
41 by carpet tile manufacturer for releasable installation.
42 C. Carpet Tile Reducer Strip: Extruded or molded heavy-duty vinyl or rubber carpet tile reducer strip of size and
43 profile recommended by carpet tile manufacturer with a minimum 2 inch wide anchorage flange. Colors as
44 selected by Owner from manufacturer's full range.
45

46 **PART 3 - EXECUTION**

- 47
48 **3.1. EXAMINATION**
49 A. Examine substrates, areas, and condition, for compliance with requirements for maximum moisture content,
50 alkalinity range, installation tolerances, and other conditions affecting carpet tile performance.
51 B. Examine Carpet Tile for type, color, pattern and potential defects.
52 C. Verify that sub-floor surfaces are dust free and free of substances (curing compounds, sealers, hardeners, etc.)
53 that could impair bonding of adhesive materials to sub-floor surfaces.
54
- 55 **3.2. PREPARATION**
56 A. General: Comply with CRI 104, Section 6.2 Site Conditions: Floor Preparation and with carpet tile manufacturer's
57 written installation instructions for preparing substrates indicated to receive carpet tile installation.
58 B. Remove existing carpet tile

- 1 C. Prepare floor substrates as recommended by flooring manufacturer.
- 2 D. Use trowelable leveling and patching compounds, according to manufacturer’s written instructions to fill cracks,
3 holes, depressions, and protrusions in substrates. Fill or level crack, holes and depressions 1/8 inch wide or
4 wider, and protrusions more than 1/32 inch, unless more stringent requirements are required by manufacture’s
5 written instructions.
- 6 E. Install trowelable leveling and patching compounds at locations where carpet tile meets ceramic tile flooring so
7 that one-half of carpet tile pile height will be above tile. Feather compound to a distance of not less than two
8 feet from edge of tile.
- 9 F. Remove coatings, including curing compounds, and other substances that are incompatible with adhesives and
10 that contain soap, wax, oil or silicone without using solvents. Use mechanical methods recommended in writing
11 by carpet tile manufacturer.
- 12 G. Broom and vacuum clean substrates to be covered immediately before installing carpet tile. Proceed with
13 installation only after unsatisfactory conditions have been corrected.

14
15 **3.3. INSTALLATION**

- 16 A. Install carpet tile in accordance with manufacturer’s instructions and CRI 104 Section 14 “Carpet Modules”.
- 17 B. Blend carpet from different cartons to ensure minimal variation in color match.
- 18 C. Apply floor adhesive uniformly to substrate in accordance with manufacturer’s instruction. Butt carpet tile edges
19 firmly together to form seams without gaps. Remove adhesive promptly from face of carpet.
- 20 D. Install edge moldings where carpet edge is exposed and at transitions to other floor coverings. Edge moldings
21 shall be securely anchored to substrate.
- 22 E. Cut and fit carpet tile to butt tightly to vertical surfaces, permanent fixtures, and built-in furniture including
23 cabinets, pipes, outlets, edgings, threshold, and nosings. Bind or seal cut edges as recommend by carpet tile
24 manufacturer.
- 25 F. Extend carpet tile into toe spaces, door reveals, closets, open-bottomed obstructions, removable flanges,
26 alcoves, and similar openings.

27
28 **3.4. CLEANING AND PROTECTION**

- 29 A. Immediately after installing carpet tile:
 - 30 1. Remove excess adhesive, seam sealer and other surface blemishes using cleaner recommended
 - 31 by carpet tile manufacturer.
 - 32 2. Remove yarns that protrude from carpet tile surface.
 - 33 3. Vacuum carpet using commercial machine with face-beater element
- 34 B. Protect installed carpet tile to comply with CRI 104, Section 16, “Protecting Indoor Installations”.

35
36
37 **END OF SECTION**

**SECTION 09 91 23
INTERIOR PAINTING**

1

2

3

4 PART 1 – GENERAL 1

5 1.1. SCOPE 1

6 1.2. RELATED REFERENCES 1

7 1.3. SUBMITTALS 1

8 1.4. QUALITY ASSURANCE 1

9 1.5. DELIVERY, STORAGE AND HANDLING 1

10 1.6. ATTIC STOCK 2

11 1.7. GUARANTEE 2

12 PART 2 - PRODUCTS 2

13 2.1. MANUFACTURERS 2

14 2.2. APPLICATION EQUIPMENT 2

15 2.3. COLORS 2

16 PART 3 - EXECUTION 2

17 3.1. EXAMINATION 2

18 3.2. PREPARATION OF SURFACES 2

19 3.3. APPLICATION 3

20 3.4. CLEANING 3

21 3.4 PAINT AND COATING SCHEDULE 3

22

PART 1 – GENERAL

1.1. SCOPE

- A. Where drawings and schedules calls for painted finishes, provide painted systems as specified herein. Work included: All interior surfaces exposed to view, unless fully factory-finished and unless otherwise indicated.
- B. Surface Preparation
- C. Do not paint over any required labels or equipment identification, performance rating, name, or nomenclature plate or data cables
- D. The term "Paint", as used herein, means all coating systems materials including primers, emulsions, epoxy, enamels, sealers, fillers and other applied materials whether used a prime, intermediate, or finish coats.

1.2. RELATED REFERENCES

- A. Work under this section depends on applicable provisions from other sections and the plan set in this contract.

1.3. SUBMITTALS

- A. Product data: Submit manufacturer’s technical information and application instructions for each material proposed for use.
- B. Samples: Provide two samples of each color and each gloss for each material on which the finish is specified to be applied.

1.4. QUALITY ASSURANCE

- A. Manufacturer Qualifications: Company specializing in manufacturing the products specified, with minimum three years documented experience.
- B. Applicator Qualifications: Company specializing in performing the type of work specified with minimum five years documented experience.
- C. Before painting is started in any area, broom clean and remove excessive dust. After painting has begun in any given area, broom cleaning will not be allowed; Cleaning shall then be done only with commercial vacuum cleaning equipment.
- D. Provide adequate illumination in all areas where painting operations are in progress.

1.5. DELIVERY, STORAGE AND HANDLING

- A. Deliver products all materials to the project site in original, new and unopened containers bearing the manufacturer’s name and label showing the following information:
 - 1. Manufacturer name; type of material
 - 2. Thinning and mixing instructions
 - 3. Manufacturer’s stock number and batch number

- 1 4. Application instructions
- 2 5. Color: Name and Number
- 3 6. Contents by volume of major pigment and vehicle constituents
- 4 B. Paint materials: Store at minimum ambient temperature of 45 degrees F and a maximum of 90 degrees F, in
- 5 ventilated area and as required by manufacturer's instructions.
- 6 C. Store all materials used on the project in protected areas designated by the City Project Manager. Keep storage
- 7 neat and clean. Remove used rags, waste and trash from the building every night and take every precaution to
- 8 avoid the risk of fire.
- 9

10 1.6. ATTIC STOCK

- 11 A. Upon completion of the work of this section, deliver to the project site, attic stock from the same production
- 12 run, identified with labels. Paint to be factory sealed and not less than one gallon of each material applied. All
- 13 stock to be inventoried and neatly located in an area designated by the project manager and provide inventory
- 14 list to the project manager.
- 15

16 1.7. GUARANTEE

- 17 A. Work and materials in this section shall be guaranteed to be free from defects for a period of one (1) year from
- 18 date of final completion of project.
- 19 B. Any defects, not due to or caused by faulty construction or material furnished or performed by other crafts, but
- 20 due to defective materials and workmanship in painting and finishing, shall be repaired and corrected by the
- 21 Painting Contractor without cost to the Owner.
- 22

23 PART 2 - PRODUCTS

24 2.1. MANUFACTURERS

- 25 A. Provide paints and finishes used in any individual system from the same manufacturer; no exceptions.
- 26 B. All paint and cleaners shall be low VOC type.
- 27 B. MANUFACTURERS: Hallman Lindsay, Pittsburg Paints, Sherwin-Williams, Diamond Vogel, Glidden
- 28 C. COLORS AND GLOSSES: Owner will select colors to be used in the various types of paint specified and will be the
- 29 sole judge of acceptability of the various glosses obtained from materials proposed to be used by the Contractor.
- 30 D. UNDERCOATS AND THINNERS: Provide undercoat paint produced by the same manufacturer as the finish coat.
- 31 Use only the thinners recommended by the paint manufacturer, and use only to the recommended limits. In so
- 32 far as practical, use undercoat, finish coat, and thinner material as parts of a unified system of paint finish.
- 33
- 34

35 2.2. APPLICATION EQUIPMENT

- 36 A. Use only such equipment as is recommended for application of the particular paint by the paint manufacturer.
- 37 B. Include all required ladders, scaffolding, drop clothes, masking, scrapers, tools, dusters, cleaning solvents, and
- 38 waste, as required to perform the work.
- 39

40 2.3. COLORS

- 41 A. BASE COLOR THROUGHOUT: Nebulous White, Sherwin Williams #SW7063
- 42 B. ACCENT COLOR: To Be Verified: Aleutian, Sherwin Williams #FN242
- 43 C. HM DOORS & FRAMES: Nebulous White, Sherwin Williams #SW7063
- 44

45 PART 3 - EXECUTION

46 3.1. EXAMINATION

- 47 A. Verify that surfaces are ready to receive work as instructed by the product manufacturer.
- 48 B. Before starting any work, carefully examine surfaces to receive paint finishes for defects which cannot be
- 49 corrected by the procedures specified herein under "Preparation of Surfaces" and which might prevent
- 50 satisfactory painting results. Do not proceed until such damages are corrected. The commencing of work in a
- 51 specific area shall be construed as acceptance of the surfaces, and thereafter the painting contractor shall be
- 52 fully responsible for satisfactory work as required herein.
- 53
- 54

55 3.2. PREPARATION OF SURFACES

- 56 A. Remove or mask hardware, accessories, device plates, lighting fixtures, factory finished work and similar items or
- 57 provide ample in-place protection. Upon completion of each space, carefully replace all removed items.

- 1 B. Clean and prepare surfaces to be painted in accordance with the manufacturer's instruction for each particular
- 2 substrate condition and as specified. Remove oil and grease prior to cleaning.
- 3 C. Seal surfaces that might cause bleed through or staining of topcoat.
- 4 D. Remove mildew from impervious surfaces by scrubbing with solution of tetra-sodium phosphate and bleach.
- 5 Rinse with clean water and allow surface to dry.
- 6 E. Masonry
- 7 1. Remove efflorescence and chalk. Do not paint surfaces if moisture content or alkalinity of surfaces or
- 8 mortar joints exceeds that permitted in manufacturer's written instructions
- 9 F. Gypsum Board
- 10 1. Repair/patch irregularities with filler compound. Sand to a smooth level surface. Use tack cloth to
- 11 remove dust and particles. Spot prime defects after repair and texture to match existing.
- 12 G. Metal doors and frames
- 13 1. Clean and sand shoulders at edge of sound paint; Touch up all bare metal with primer.
- 14

15 3.3. APPLICATION

- 16 A. Apply paint in accordance with manufacturer's directions. Use applicators and techniques best suited for
- 17 substrate and type of material being applied.
- 18 B. Do not paint over dirt, rust, scale, grease, moisture, scuffed surfaces, or conditions detrimental to formation of a
- 19 durable paint film.
- 20 C. Apply materials under adequate illumination, evenly spread and flowed on smoothly to avoid runs, sags, brush
- 21 marks, air bubbles, excessive roller stipple or other surface imperfections. Cut in sharp lines and color breaks.
- 22 D. Apply materials at not less than the manufacture's recommended spreading rate. Provide a total dry film
- 23 thickness of the entire system as recommended by the manufacturer.
- 24 E. Coverage and hide shall be complete. When color, stain, dirt or undercoats show through final coat of paint, the
- 25 surface shall be covered by additional coats until the paint film is of uniform finish, color, appearance and
- 26 coverage, at no additional cost to the Owner.
- 27 F. Paint metal doors interior faces to the suite, including, top, bottom and side edges to match.
- 28

29 3.4. CLEANING

- 30 A. Collect waste material that could constitute a fire hazard, place in closed metal containers, and remove daily
- 31 from site.
- 32 B. At end of each workday, remove empty cans, rags, trash and other discarded paint materials from the project
- 33 site.
- 34 C. After completing paint application, clean spattered surfaces. Remove spattered paints by washing, scraping, or
- 35 other methods. Do not scratch or damage adjacent finished surfaces.
- 36 D. Provide "Wet Paint" signage to protect newly painted surfaces.
- 37

38 3.4 PAINT AND COATING SCHEDULE

- 39 A. Surfaces to be painted as indicated on the drawings.
- 40 B. High Performance Architectural Latex System
- 41 C. Interior Gypsum Board Surfaces to be painted:
- 42 1. One top coat: Interior Eggshell Latex with the exception of the following:
- 43 a. Restrooms, Breakrooms and Locker Rooms shall have Latex Semi-Gloss finish.
- 44 D. Metal Surfaces to be painted including but not limited to doors and door frames
- 45 1. One top coat: Interior Eggshell Latex
- 46 E. Interior CMU and concrete to be painted:
- 47 1. One top coat: Interior Eggshell Latex
- 48

49
50

END OF SECTION

EXHIBIT "C"**A & A Environmental, Inc.**

N4381 US Hwy 51 • Poynette, WI 53955

Phone: (608) 240-1511 • Mobile Phone: (608) 576-4960 • Pager: (608) 275-5377

Fax: (608) 635-9717

June 5, 2008

Mr. James C. Whitney
City of Madison
215 Martin Luther King Jr. Blvd, Room 115
Madison, WI 53703
(608) 266-4563, Fax (608) 264-9275, Cell (608) 575-5269

RE: 210 MLK Jr. Project – Central District Police Station – Ground Floor Remodel

On May 22, 2008 an asbestos inspection for renovation was completed on Phases 1 and 2 of the Central District Police Station remodel area at 210 Martin Luther King Jr. Blvd. The metal pan ceiling was opened in eleven different locations throughout the area to be renovated. There were asbestos fittings on heating and plumbing lines located directly above most of the areas. Even though the heating line fittings did not have canvas over the asbestos insulation cement, no contamination could be found on top of the ceiling. Caution should be taken by the renovation contractor to insure the TSI fittings are not damaged when removing the metal pan ceiling.

The following building materials tested positive for asbestos:

1. Black glue on the back of the cork panels in the detective area (24 Sq Ft).
2. Ceiling caulk in men's locker room (207 Lin Ft or 51.75 Sq Ft).
3. Ceiling caulk in women's locker room (90 Lin Ft or 22.5 Sq Ft).
4. TSI fittings on heating and plumbing lines above the ceilings (1,160 fittings).
5. Transite in the fume hood (48 Sq Ft).

Please note that the fitting count is only an estimate off of the plans provided. There most likely will be more. Once the pan ceilings are removed an accurate count can be made.

There are asbestos fittings in the block wall around the locker rooms and bathrooms. These fittings can only be accessed by demolishing the block walls around the plumbing lines. A&A environmental, Inc. was not able to find ductwork that was covered with black tar paper that was present on previous floors.

A&A Environmental, Inc. sampled the plumbing lines covered with black colored paper and tar material. The line that was sampled was reported as no asbestos detected. Other building materials sampled and reported as no asbestos detected are as follows.

1. 9 x 9 floor tiles
2. Floor tile mastic
3. Plaster
4. Drywall
5. Drywall compound
6. Base cove
7. Base cove mastic
8. Ceramic tile grout
9. Ceramic tile glue
10. Ceiling tiles
11. 12 x 12 floor tile
12. Yellow carpet mastic
13. Cream floor tile mastic
14. Fiberboard

In room GR50 there may be glue under the drywall however A&A Environmental, Inc. was asked not to put holes in this wall. The wood chair rail is only nailed where as in other parts of the building the chair rail was held in place with asbestos glue.

If you have any questions concerning this report or the sampling performed please feel free to contact me.

Sincerely,

Kim Sopha

President/Inspector #AII01851

Encl

KAS/bls

EMC LABS, INC.

Laboratory Report

0064897

9830 S. 51st Street, Suite B109, Phoenix, AZ 85044
 Phone: 800-362-3373 or 480-940-5294 - Fax: (480) 893-1726

Bulk Asbestos Analysis by Polarized Light Microscopy

NVLAP#101926-0

Client: A & A ENVIRONMENTAL, INC.	Job# / P.O. #: AA1728
Address: N4381 US HWY 51	Date Received: 05/27/2008
POYNETTE WI 53955	Date Analyzed: 05/28/2008
Collected: 05/22/2008	Date Reported: 05/28/2008
Project Name/ 210 MLK GROUND FLOOR	EPA Method: EPA 600/M4-82-020
Address:	Submitted By: KIM SOPHA
	Collected By: Customer

Lab ID Client ID	Sample Location	Layer Name / Sample Description	Asbestos Detected	Asbestos Type (%)	Non-Asbestos Constituents
0064897-001 AA1728-01	EXECUTIVE OFFICE WALL	Drywall Compound, White/ Lt. Gray	No		Carbonates Mica Quartz Binder/Filler 100%
0064897-002 AA1728-02	EXECUTIVE OFFICE WALL	Drywall, White/ Brown	No		Cellulose Fiber 10% Fibrous Glass 2% Gypsum Carbonates Mica Quartz 88%
0064897-003 AA1728-03	EXECUTIVE OFFICE WALL	Top Coat Plaster, White/ Lt. Gray	No		Cellulose Fiber <1% Gypsum Carbonates Mica Binder/Filler 99%
0064897-004 AA1728-04	EXECUTIVE OFFICE WALL	Base Coat Plaster, Beige	No		Cellulose Fiber <1% Carbonates Quartz Gypsum Mica 99%
0064897-005 AA1728-05	EXECUTIVE OFFICE WALL	Top Coat Plaster, White	No		Gypsum Carbonates Mica Binder/Filler 100%
0064897-006 AA1728-06	EXECUTIVE OFFICE WALL	Base Coat Plaster, Beige	No		Cellulose Fiber <1% Carbonates Quartz Binder/Filler 99%

EMC LABS, INC.

9830 S. 51st Street, Suite B109, Phoenix, AZ 85044
 Phone: 800-362-3373 or 480-940-5294 - Fax: (480) 893-1726

Laboratory Report

0064897**Bulk Asbestos Analysis by Polarized Light Microscopy**

NVI.AP#101926-0

Client:	A & A ENVIRONMENTAL, INC.	Job# / P.O. #:	AA1728
Address:	N4381 US HWY 51 POYNETTE WI 53955	Date Received:	05/27/2008
Collected:	05/22/2008	Date Analyzed:	05/28/2008
Project Name/	210 MLK GROUND FLOOR	Date Reported:	05/28/2008
Address:		EPA Method:	EPA 600/M4-82-020
		Submitted By:	KIM SOPHA
		Collected By:	Customer

Lab ID Client ID	Sample Location	Layer Name / Sample Description	Asbestos Detected	Asbestos Type (%)	Non-Asbestos Constituents
0064897-007 AA1728-07	EXECUTIVE OFFICE WALL	Top Coat Plaster, White/ Lt. Gray	No		Gypsum Carbonates Mica Binder/Filler 100%
0064897-008 AA1728-08	EXECUTIVE OFFICE WALL	Base Coat Plaster, Lt. Gray	No		Cellulose Fiber <1% Carbonates Quartz Gypsum Perlite 99%
0064897-009 AA1728-09	ROOM GR8	9"x9" Floor Tile, Gray	No		Carbonates Quartz Binder/Filler 100%
0064897-010 AA1728-10	ROOM GR8	Floor Tile Mastic, Yellow	No		Carbonates Quartz Mica Binder/Filler 100%
0064897-011 AA1728-11	ABOVE WINDOW DIVIDERS	Fiber Board, White/ Brown	No		Cellulose Fiber 90% Gypsum Binder/Filler 10%
0064897-012 AA1728-12	ROOF DRAIN	LAYER 1 Tar, Black	No		Fibrous Glass 5% Carbonates Binder/Filler 95%
		LAYER 2 Insulation, Yellow	No		Fibrous Glass 97% Carbonates 3%
0064897-013 AA1728-13	ROOF DRAIN FITTINGS	Paper, Black	No		Cellulose Fiber 60% Carbonates Binder/Filler 40%

EMC LABS, INC.

Laboratory Report

00648979830 S. 51st Street, Suite B109, Phoenix, AZ 85044
Phone: 800-362-3373 or 480-940-5294 - Fax: (480) 893-1726**Bulk Asbestos Analysis by Polarized Light Microscopy**

NVLAP#101926-0

Client:	A & A ENVIRONMENTAL, INC.	Job# / P.O. #:	AA1728
Address:	N4381 US HWY 51 POYNETTE WI 53955	Date Received:	05/27/2008
Collected:	05/22/2008	Date Analyzed:	05/28/2008
Project Name/	210 MLK GROUND FLOOR	Date Reported:	05/28/2008
Address:		EPA Method:	EPA 600/M4-82-020
		Submitted By:	KIM SOPHA
		Collected By:	Customer

Lab ID Client ID	Sample Location	Layer Name / Sample Description	Asbestos Detected	Asbestos Type (%)	Non-Asbestos Constituents
0064897-014 AA1728-14	ROOF DRAIN	TSI Fitting, Gray	Yes	Chrysotile 15%	Mineral Wool 45% Gypsum Mica Binder/Filler 40%
0064897-015 AA1728-15	HEATING LINE	TSI Fitting, Gray	Yes	Chrysotile 20%	Mineral Wool 50% Gypsum Mica Binder/Filler 30%
0064897-016 AA1728-16	EXECUTIVE WEST	Ceramic Floor Tile Grout, Gray	No		Cellulose Fiber <1% Gypsum Quartz Carbonates Binder/Filler 99%
0064897-017 AA1728-17	EXECUTIVE WEST	Ceramic Floor Tile Thin Set, Gray	No		Gypsum Quartz Binder/Filler 100%
0064897-018 AA1728-18	NW WALL	Top Coat Plaster, White/ Lt. Gray	No		Gypsum Carbonates Mica Binder/Filler 100%
0064897-019 AA1728-19	NW WALL	Base Coat Plaster, Beige	No		Carbonates Quartz Binder/Filler 100%
0064897-020 AA1728-20	CARPET NW	Carpet Mastic, Yellow	No		Cellulose Fiber <1% Carbonates Quartz Binder/Filler 99%

EMC LABS, INC.

Laboratory Report

00648979830 S. 51st Street, Suite B109, Phoenix, AZ 85044
Phone: 800-362-3373 or 480-940-5294 - Fax: (480) 893-1726**Bulk Asbestos Analysis by Polarized Light Microscopy**

NVLAP#101926-0

Client:	A & A ENVIRONMENTAL, INC.	Job# / P.O. #:	AA1728
Address:	N4381 US HWY 51 POYNETTE WI 53955	Date Received:	05/27/2008
Collected:	05/22/2008	Date Analyzed:	05/28/2008
Project Name/	210 MLK GROUND FLOOR	Date Reported:	05/28/2008
Address:		EPA Method:	EPA 600/M4-82-020
		Submitted By:	KIM SOPHA
		Collected By:	Customer

Lab ID Client ID	Sample Location	Layer Name / Sample Description	Asbestos Detected	Asbestos Type (%)	Non-Asbestos Constituents
0064897-021 AA1728-21	GLASS FRAME NORTH	LAYER 1 Drywall, White/ Brown	No		Cellulose Fiber 10%
		LAYER 2 Texture / Paint, Lt. Gray Note: Sample is mainly Paint - no Texture present	No		Gypsum Carbonates Mica Quartz 90% Cellulose Fiber 1% Carbonates Binder/Filler 99%
0064897-022 AA1728-22	MEETING ROOM WALL	Top Coat Plaster, White	No		Cellulose Fiber <1% Gypsum Carbonates Mica Binder/Filler 99%
0064897-023 AA1728-23	MEETING ROOM WALL	Base Coat Plaster, Beige	No		Cellulose Fiber <1% Carbonates Quartz Gypsum Mica 99%
0064897-024 AA1728-24	MEETING ROOM	9"x9" Floor Tile, Gray	No		Cellulose Fiber 2% Carbonates Quartz Binder/Filler 98%
0064897-025 AA1728-25	MEETING ROOM	Floor Tile Mastic, Yellow/ Black	No		Cellulose Fiber 1% Carbonates Quartz Binder/Filler 99%
0064897-026 AA1728-26	MEETING ROOM	Floor Tile Mastic, Cream	No		Cellulose Fiber <1% Carbonates Quartz Binder/Filler 99%

EMC LABS, INC.

Laboratory Report

0064897

9830 S. 51st Street, Suite B109, Phoenix, AZ 85044
 Phone: 800-362-3373 or 480-940-5294 - Fax: (480) 893-1726

Bulk Asbestos Analysis by Polarized Light Microscopy

NVI.AP#101926-0

Client:	A & A ENVIRONMENTAL, INC.	Job# / P.O. #:	AA1728
Address:	N4381 US HWY 51 POYNETTE WI 53955	Date Received:	05/27/2008
Collected:	05/22/2008	Date Analyzed:	05/28/2008
Project Name/	210 MLK GROUND FLOOR	Date Reported:	05/28/2008
Address:		EPA Method:	EPA 600/M4-82-020
		Submitted By:	KIM SOPHA
		Collected By:	Customer

Lab ID Client ID	Sample Location	Layer Name / Sample Description	Asbestos Detected	Asbestos Type (%)	Non-Asbestos Constituents
0064897-027 AA1728-27	PARTITION WALL DETECTIVE AREA	LAYER 1 Drywall, White/ Brown	No		Cellulose Fiber 10%
		LAYER 2 Wall Covering, White/ Brown	No		Gypsum Carbonates Mica 90% Cellulose Fiber 60% Carbonates Binder/Filler 40%
0064897-028 AA1728-28	WALL	Top Coat Plaster, White/ Lt. Gray	No		Cellulose Fiber <1% Gypsum Carbonates Mica Binder/Filler 99%
0064897-029 AA1728-29	WALL	Base Coat Plaster, Lt. Gray	No		Gypsum Quartz Carbonates Perlite 100%
0064897-030 AA1728-30	WINDOW DETECTIVE AREA	LAYER 1 Glue, Black	Yes	Chrysotile 3%	Carbonates Binder/Filler 97%
		LAYER 2 Cork, White/ Brown	No		Cork Carbonates Binder/Filler 100%

EMC LABS, INC.

Laboratory Report

0064897

9830 S. 51st Street, Suite B109, Phoenix, AZ 85044
 Phone: 800-362-3373 or 480-940-5294 - Fax: (480) 893-1726

Bulk Asbestos Analysis by Polarized Light Microscopy

NVLAP#101926-0

Client:	A & A ENVIRONMENTAL, INC.	Job# / P.O. #:	AA1728
Address:	N4381 US HWY 51 POYNETTE WI 53955	Date Received:	05/27/2008
Collected:	05/22/2008	Date Analyzed:	05/28/2008
Project Name/	210 MILK GROUND FLOOR	Date Reported:	05/28/2008
Address:		EPA Method:	EPA 600/M4-82-020
		Submitted By:	KIM SOPHA
		Collected By:	Customer

Lab ID Client ID	Sample Location	Layer Name / Sample Description	Asbestos Detected	Asbestos Type (%)	Non-Asbestos Constituents
0064897-031 AA1728-31	PARTITION WALL DETECTIVE AREA	LAYER 1 Drywall, White/ Brown	No		Cellulose Fiber 10%
		LAYER 2 Wall Covering, White/ Brown	No		Gypsum Carbonates Mica 90% Cellulose Fiber 60% Carbonates Binder/Filler 40%
0064897-032 AA1728-32	FREN PARTITION WALL	Drywall, White Note: No Paper Backing Present	No		Cellulose Fiber 3% Gypsum Carbonates Mica 97%
0064897-033 AA1728-33	FREN	Drywall, White Note: No Paper Backing Present	No		Cellulose Fiber 3% Gypsum Carbonates Mica 97%
0064897-034 AA1728-34	FREN	2x4 Ceiling Tile, White/ Beige	No		Cellulose Fiber 40% Mineral Wool 40% Carbonates Perlite Binder/Filler 20%
0064897-035 AA1728-35	FREN WALL	Top Coat Plaster, White/ Beige	No		Gypsum Carbonates Mica Binder/Filler 100%
0064897-036 AA1728-36	FREN WALL	Base Coat Plaster, Beige	No		Cellulose Fiber <1% Carbonates Quartz Gypsum Binder/Filler 99%

EMC LABS, INC.

Laboratory Report

0064897

9830 S. 51st Street, Suite B109, Phoenix, AZ 85044

Phone: 800-362-3373 or 480-940-5294 - Fax: (480) 893-1726

Bulk Asbestos Analysis by Polarized Light Microscopy

NVLAP#101926-0

Client:	A & A ENVIRONMENTAL, INC.	Job# / P.O. #:	AA1728
Address:	N4381 US HWY 51 POYNETTE WI 53955	Date Received:	05/27/2008
Collected:	05/22/2008	Date Analyzed:	05/28/2008
Project Name/	210 MLK GROUND FLOOR	Date Reported:	05/28/2008
Address:		EPA Method:	EPA 600/M4-82-020
		Submitted By:	KIM SOPHA
		Collected By:	Customer

Lab ID Client ID	Sample Location	Layer Name / Sample Description	Asbestos Detected	Asbestos Type (%)	Non-Asbestos Constituents
0064897-037 AA1728-37	FREN	Carpet Mastic, Yellow	No		Synthetic Fiber 3% Carbonates Quartz Binder/Filler 97%
0064897-038 AA1728-38	PHOTO LAB	2x2 Ceiling Tile, White/ Off White	No		Mineral Wool 80% Gypsum Carbonates Binder/Filler 20%
0064897-039 AA1728-39	PHOTO LAB	Carpet Mastic, Green/ Clear/ Yellow	No		Synthetic Fiber 1% Carbonates Quartz Binder/Filler 99%
0064897-040 AA1728-40	PHOTO LAB	LAYER 1 Glue, Red/ Yellow	No		Carbonates Quartz Binder/Filler 100%
		LAYER 2 Cork, Tan/ Lt. Brown	No		Cork Carbonates Binder/Filler 100%
0064897-041 AA1728-41	PHOTO LAB	12"x12" Floor Tile, White/ Gray	No		Carbonates Quartz Binder/Filler 100%
0064897-042 AA1728-42	PHOTO LAB	12"x12" Floor Tile Mastic, Yellow	No		Cellulose Fiber 2% Carbonates Quartz Binder/Filler 98%
0064897-043 AA1728-43	PHOTO LAB	2x2 Ceiling Tile, White/ Off White	No		Mineral Wool 80% Cellulose Fiber <1% Carbonates Binder/Filler 19%

EMC LABS, INC.

Laboratory Report

00648979830 S. 51st Street, Suite B109, Phoenix, AZ 85044
Phone: 800-362-3373 or 480-940-5294 - Fax: (480) 893-1726**Bulk Asbestos Analysis by Polarized Light Microscopy**

NVLAP#101926-0

Client:	A & A ENVIRONMENTAL, INC.	Job# / P.O. #:	AA1728
Address:	N4381 US HWY 51 POYNETTE WI 53955	Date Received:	05/27/2008
Collected:	05/22/2008	Date Analyzed:	05/28/2008
Project Name/	210 MILK GROUND FLOOR	Date Reported:	05/28/2008
Address:		EPA Method:	EPA 600/M4-82-020
		Submitted By:	KIM SOPHA
		Collected By:	Customer

Lab ID Client ID	Sample Location	Layer Name / Sample Description	Asbestos Detected	Asbestos Type (%)	Non-Asbestos Constituents
0064897-044 AA1728-44	PHOTO LAB	Ceramic Floor Tile Thin Set, Lt. Gray	No		Carbonates Quartz Gypsum Binder/Filler 100%
0064897-045 AA1728-45	PHOTO LAB	Ceramic Floor Tile Grout, Gray	No		Gypsum Quartz Carbonates Binder/Filler 100%
0064897-046 AA1728-46	PHOTO LAB DOOR PATCH	Drywall, White/ Brown	No		Cellulose Fiber 10% Fibrous Glass 2% Gypsum Carbonates Mica Quartz 88%
0064897-047 AA1728-47	PHOTO LAB, ON WALLS	Glue, Yellow/ Beige	No		Carbonates Quartz Binder/Filler 100%
0064897-048 AA1728-48	PHOTO LAB	12"x12" Floor Tile, White/ Gray	No		Carbonates Quartz Binder/Filler 100%
0064897-049 AA1728-49	PHOTO LAB	Floor Tile Mastic, Yellow	No		Synthetic Fiber 1% Carbonates Quartz Binder/Filler 99%
0064897-050 AA1728-50	PHOTO LAB	Basecove, Gray	No		Carbonates Binder/Filler 100%

EMC LABS, INC.

Laboratory Report

00648979830 S. 51st Street, Suite B109, Phoenix, AZ 85044
Phone: 800-362-3373 or 480-940-5294 - Fax: (480) 893-1726**Bulk Asbestos Analysis by Polarized Light Microscopy**

NVLAP#101926-0

Client:	A & A ENVIRONMENTAL, INC.	Job# / P.O. #:	AA1728
Address:	N4381 US HWY 51 POYNETTE WI 53955	Date Received:	05/27/2008
Collected:	05/22/2008	Date Analyzed:	05/28/2008
Project Name/	210 MLK GROUND FLOOR	Date Reported:	05/28/2008
Address:		EPA Method:	EPA 600/M4-82-020
		Submitted By:	KIM SOPHA
		Collected By:	Customer

Lab ID Client ID	Sample Location	Layer Name / Sample Description	Asbestos Detected	Asbestos Type (%)	Non-Asbestos Constituents
0064897-051 AA1728-51	PHOTO LAB	Bascoove Glue, Yellow	No		Non-Fibrous Tremolite 3% Carbonates Quartz Binder/Filler 97%
0064897-052 AA1728-52	PHOTO LAB	Wall Caulking/ Door Caulking, Lt. Gray	No		Carbonates Binder/Filler 100%
0064897-053 AA1728-53	ROOM GR 68 WALL	Top Coat Plaster, White/ Lt. Gray	No		Cellulose Fiber <1% Gypsum Carbonates Mica Binder/Filler 99%
0064897-054 AA1728-54	ROOM GR 68 WALL	Base Coat Plaster, Lt. Gray	No		Carbonates Quartz Gypsum Perlite Binder/Filler 100%
0064897-055 AA1728-55	GR 45A WALL	LAYER 1 Drywall, Off White/ Brown	No		Cellulose Fiber 10% Fibrous Glass 2% Gypsum Carbonates Mica Quartz 88%
		LAYER 2 Joint Compound, White	No		Carbonates Mica Binder/Filler 100%
0064897-056 AA1728-56	GR 45A WALL	Drywall Compound, White/ Lt. Gray	No		Carbonates Mica Binder/Filler 100%

EMC LABS, INC.

Laboratory Report

00648979830 S. 51st Street, Suite B109, Phoenix, AZ 85044
Phone: 800-362-3373 or 480-940-5294 - Fax: (480) 893-1726**Bulk Asbestos Analysis by Polarized Light Microscopy**

NVLAP#101926-0

Client:	A & A ENVIRONMENTAL, INC.	Job# / P.O. #:	AA1728
Address:	N4381 US HWY 51 POYNETTE WI 53955	Date Received:	05/27/2008
Collected:	05/22/2008	Date Analyzed:	05/28/2008
Project Name/	210 MLK GROUND FLOOR	Date Reported:	05/28/2008
Address:		EPA Method:	EPA 600/M4-82-020
		Submitted By:	KIM SOPHA
		Collected By:	Customer

Lab ID Client ID	Sample Location	Layer Name / Sample Description	Asbestos Detected	Asbestos Type (%)	Non-Asbestos Constituents
0064897-057 AA1728-57	MENS LOCKER ROOM	Ceramic Floor Tile Grout, Gray	No		Cellulose Fiber <1% Carbonates Quartz Gypsum Binder/Filler 99%
0064897-058 AA1728-58	MENS LOCKER ROOM	LAYER 1 Ceramic Floor Tile Thin Set, Gray Note: Very small amount of sample	No		Carbonates Quartz Binder/Filler 100%
		LAYER 2 Ceramic Floor Tile, White	No		Gypsum Quartz Carbonates Binder/Filler 100%
0064897-059 AA1728-59	MENS LOCKER ROOM	Ceiling Caulk, Lt. Gray	Yes	Chrysotile 5%	Carbonates Binder/Filler 95%
0064897-060 AA1728-60	GYM	Drywall, Brown	No		Cellulose Fiber 10% Gypsum Carbonates Mica 90%
0064897-061 AA1728-61	REBECCA REPAAL'S OFFICE	Drywall Compound, White/ Lt. Gray	No		Cellulose Fiber <1% Carbonates Perlite Mica Binder/Filler 99%

EMC LABS, INC.

Laboratory Report

00648979830 S. 51st Street, Suite B109, Phoenix, AZ 85044
Phone: 800-362-3373 or 480-940-5294 - Fax: (480) 893-1726**Bulk Asbestos Analysis by Polarized Light Microscopy**

NVLAP#101926-0

Client:	A & A ENVIRONMENTAL, INC.	Job# / P.O. #:	AA1728
Address:	N4381 US HWY 51 POYNETTE WI 53955	Date Received:	05/27/2008
Collected:	05/22/2008	Date Analyzed:	05/28/2008
Project Name/	210 MLK GROUND FLOOR	Date Reported:	05/28/2008
Address:		EPA Method:	EPA 600/M4-82-020
		Submitted By:	KIM SOPHA
		Collected By:	Customer

Lab ID Client ID	Sample Location	Layer Name / Sample Description	Asbestos Detected	Asbestos Type (%)	Non-Asbestos Constituents
0064897-062 AA1728-62	REBECCA REPAAL'S OFFICE	LAYER 1 Drywall, Off White/ Brown	No		Cellulose Fiber 10% Fibrous Glass 2% Gypsum Carbonates Mica 88%
		LAYER 2 Joint Compound, White	No		Cellulose Fiber 2% Carbonates Mica Quartz Binder/Filler 98%
0064897-063 AA1728-63	REBECCA REPAAL'S OFFICE	Basecove, Black	No		Carbonates Gypsum Binder/Filler 100%
0064897-064 AA1728-64	REBECCA REPAAL'S OFFICE	Basecove Glue, Off White	No		Carbonates Binder/Filler 100%
0064897-065 AA1728-65	JULIE BEYLER'S OFFICE	Drywall, White/ Brown	No		Cellulose Fiber 10% Gypsum Carbonates Mica 90%
0064897-066 AA1728-66	JULIE BEYLER'S OFFICE	Window Caulking, White/ Cream	No		Carbonates Gypsum Binder/Filler 100%
0064897-067 AA1728-67	CEILING	2x2 Ceiling Tile, White/ Beige	No		Cellulose Fiber 80% Mineral Wool 2% Perlite Gypsum Carbonates Binder/Filler 18%

EMC LABS, INC.

Laboratory Report

00648979830 S. 51st Street, Suite B109, Phoenix, AZ 85044
Phone: 800-362-3373 or 480-940-5294 - Fax: (480) 893-1726**Bulk Asbestos Analysis by Polarized Light Microscopy**

NVLAP#101926-0

Client:	A & A ENVIRONMENTAL, INC.	Job# / P.O. #:	AA1728
Address:	N4381 US HWY 51 POYNETTE WI 53955	Date Received:	05/27/2008
Collected:	05/22/2008	Date Analyzed:	05/28/2008
Project Name/	210 MLK GROUND FLOOR	Date Reported:	05/28/2008
Address:		EPA Method:	EPA 600/M4-82-020
		Submitted By:	KIM SOPHA
		Collected By:	Customer

Lab ID Client ID	Sample Location	Layer Name / Sample Description	Asbestos Detected	Asbestos Type (%)	Non-Asbestos Constituents
0064897-068 AA1728-68	CEILING	2x2 Ceiling Tile, White/ Beige	No		Cellulose Fiber 80% Mineral Wool 2% Perlite Gypsum Carbonates Binder/Filler 18%
0064897-069 AA1728-69	EAST OFFICE	Drywall Compound, White/ Off White	No		Carbonates Mica Quartz Binder/Filler 100%
0064897-070 AA1728-70	EAST OFFICE	LAYER 1 Drywall, White/ Brown	No		Cellulose Fiber 10% Fibrous Glass 2% Gypsum Carbonates Mica 88%
		LAYER 2 Joint Compound, White/ Beige	No		Cellulose Fiber 2% Carbonates Mica Quartz Binder/Filler 98%
0064897-071 AA1728-71	JULIE BEYLER'S OFFICE	Carpet Mastic, Yellow	No		Synthetic Fiber 1% Cellulose Fiber <1% Carbonates Gypsum Quartz Binder/Filler 98%
0064897-072 AA1728-72	215 MLK ROOM 322, AROUND AC UNIT	Caulk, Off White	No		Cellulose Fiber <1% Gypsum Carbonates Binder/Filler 99%

EMC LABS, INC.

9830 S. 51st Street, Suite B109, Phoenix, AZ 85044
 Phone: 800-362-3373 or 480-940-5294 - Fax: (480) 893-1726

Laboratory Report
0064897

Bulk Asbestos Analysis by Polarized Light Microscopy

NVLAP#101926-0

Client:	A & A ENVIRONMENTAL, INC.	Job# / P.O. #:	AA1728
Address:	N4381 US HWY 51 POYNETTE WI 53955	Date Received:	05/27/2008
Collected:	05/22/2008	Date Analyzed:	05/28/2008
Project Name/	210 MLK GROUND FLOOR	Date Reported:	05/28/2008
Address:		EPA Method:	EPA 600/M4-82-020
		Submitted By:	KTM SOPHA
		Collected By:	Customer

Lab ID Client ID	Sample Location	Layer Name / Sample Description	Asbestos Detected	Asbestos Type (%)	Non-Asbestos Constituents
0064897-073 AA1728-73	215 MLK ROOM 312, AROUND AC UNIT	Caulk, Off White	No		Cellulose Fiber 1% Gypsum Carbonates Binder/Filler 99%

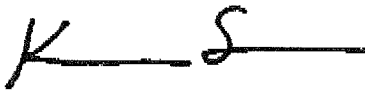

Analyst - Kenneth Scheske



Signatory - Lab Director - Kurt Kettler

Distinctly stratified, easily separable layers of samples are analyzed as sub-samples of the whole and are reported separately for each discernible layer. All analyses are derived from calibrated visual estimates and measured in weight percent unless otherwise noted. The report applies to the standards or procedures identified and to the sample(s) tested. The test results are not necessarily indicative or representative of the quality of the lot from which the sample was taken or of apparently identical or similar products, nor do they represent an ongoing quality assurance program unless so noted. These reports are for the exclusive use of the addressed client and that they will not be reproduced wholly or in part for advertising or other purposes over our signature or in connection with our name without special written permission. The report shall not be reproduced except in full, without written approval by our laboratory. The samples not destroyed in testing are retained a maximum of thirty days. The laboratory measurement of uncertainty for the test method is approximately ±1% by weight. Accredited by the National Institute of Standards and Technology, Voluntary Laboratory Accreditation Program for selected test methods for asbestos. The accreditation or any reports generated by this laboratory in no way constitutes or implies product certification, approval, or endorsement by the National Institute of Standards and Technology. The report must not be used by any entity to claim product endorsement by NVLAP or any agency of the U.S. Government. Polarized Light Microscopy may not be consistently reliable in detecting asbestos in floor coverings and similar non-fibrous organically bound materials.